

THE WELL

**Kemsing Village Magazine
with news from Woodlands**

New Vicarage and Church Hall plans—see Centre Pages

Spring 2013

No 189

CONTENTS - The Well Spring 2013 No 189

Easter Services	3	New Church Hall and Vicarage	15/16/17
Vicar's letter	4	Life on the Hill	19
Church Services	5	School Report	21
Community Choir	7	Helping Hand Driving Scheme	23
Dads and Bacon	7	Fund Raising	23
APCM & Churchyard	9	Cotmans Ash	25
Parish Council News	11	Tom Dew	26
News and Notes	13	Family Milestones	28
		New Scout Centre	30

Editorial Team:- Doreen Farrow, Janet Eaton & Rosemary Banister
We reserve the right to edit [i.e. cut, précis, alter, correct grammar or spelling] any item published, and our decision is final.

Cover picture shows a *papaver orientalis* 'Patty's Plum' .

Cover Picture by Doreen Farrow

COPY FOR NEXT ISSUE

Please submit any items or articles for the next issue of The Well before
1st May 2013 to welleditors@hotmail.co.uk

THE WELL - is published and distributed free, four times a year by the Parochial Church Councils of St Mary's Church, Kemsing and St Mary's Church, Woodlands, to encourage and stimulate the life of the community. The views expressed in the magazine do not necessarily represent official church opinion or policy.

If you use a computer to type your article, it would be extremely helpful if you could Email it to: welleditors@hotmail.co.uk or send to the Editors c/o Poppies Cottage, 3, St. Edith's Road, Kemsing TN15 6PT,

For postal subscriptions, contact Debbie Pierson—01732 762033

Easter Services at Kemsing & Woodlands *Celebrate with us this Easter!*

Thur 28th Mar (Maundy Thursday)

7.45 pm Communion service

Friday 29th Mar (Good Friday)

9.30 am All-age worship in Kemsing Church

10.30 am Open-air service on Green Hill

followed by

Hot Cross Buns in Kemsing Church Hall

At the cross ↖

1.30-3.00 pm Service of Reflection

Sunday 31st Mar (Easter Day)

8.00 am Traditional Communion in Kemsing

10.00 am All-age Communion in Kemsing

11.30 am Communion at Woodlands

7.00 pm Easter Carol Service

Vicar's Letter



Dear Friends

After a dry spell, we've had so much rain and snow that the aquifers and reservoirs are full to bursting. This leaves us all wondering: What will next summer be like? I have a small, tattered clipping that I sometimes carry with me and pull out for purposes of private amusement. It is a weather forecast from the Western Daily Mail and it says, in toto: "Outlook: Dry and warm, but cooler with some rain." (Bill Bryson, *Notes from a Small Island*).

"Praise the Lord for times and seasons, cloud and sunshine, wind and rain; spring to melt the snows of winter till the waters flow again." (Timothy Dudley-Smith, *Fill our Hearts with Joy and Gladness*)

"God gives snow like wool; he scatters hoarfrost like ashes. He hurls down his crystals of ice like crumbs; who can stand before his cold? He sends out his word, and melts them; he makes his wind blow and the waters flow." (The Bible, *Psalms 147:16-18*).

The Bible's teaching is that the weather and the seasons are part of the way God has made the world. He has deliberately designed there to be an annual cycle of winter, with new life breaking out each spring, before everything dies down again in the autumn, and then round it goes again.

There is a reason why the world has been designed in this way. God has ordered the natural world so that life comes out of death, that day follows night, that spring comes after winter. He wants to point us to the fact that this is the pattern for the whole world. God wanted to give life to the world, but he could only do so after Jesus gave up his life for the world – paying the price of our sin. Those who follow Jesus receive forgiveness, adoption into God's family, and the promise of the fullest life for all eternity – but they only do so after giving up control of their lives to Jesus, recognising him to be the master. Indeed the whole history of our world is that God's good purposes for it are achieved only after we have failed and God has intervened to rescue it.

Resurrection and life follow death.

This is what we celebrate every Easter. This spring is no exception – come and join us in celebrating the God who brings life out of death.

With every blessing. Your friend and vicar,

A handwritten signature in black ink that reads "James". The letters are cursive and slightly slanted.

James Oakley

St MARY the VIRGIN PARISH CHURCH, KEMSING

www.kemsingwithwoodlands.org

Vicar	Rev. James Oakley	01732 762556
Wardens	Ray Parton	01959 523045
	Jean Walker	01732 761646
Parish Office	Margaret Robarts	01732 761351
Readers	Mary Quenby	01959 522079
	Philip Walker	01732 761646
	Ruth Mason	01959 524486

The Parish Office (in the Church Hall) is open from 10am-noon on Mon. and 10.00 - 5pm on Thursdays. Answerphone at other times is 01732 761351.

Apart from 5th Sunday, the pattern of services is as follows:

- 08.00 Communion in traditional language
- 09.15 Sung Communion service (followed by coffee in the Church Hall)
- 10.30 Morning Service (with coffee in the Church Hall beforehand) Sunday Special on every Sunday apart from 1st Sunday of the month.
- 18.30 Evening Service (Evensong twice a month, a number of other formats twice a month)

The combined communion service on the fifth Sunday will usually be held in Kemsing Church because of seating and parking limitations in Woodlands.

The service pattern on this Sunday will be:

- 08.00 BCP Matins
- 09.00 Breakfast in the Church Hall
- 10.00 Combined service with Woodlands
- 18.30 Evensong

At the All-Age service on **Palm Sunday** (10.30am on Sunday 24th March) children will have the chance to dress up in costume for a 'Palm Sunday Procession'. If you have suitable clothes at home, please bring them on that day; we will also have costumes available for those for whom that is helpful. Come to the Church Hall at 10am and join us for refreshments

SERVICES at St. Mary's Woodlands

1st Sunday	4.30	Evening Praise
2nd Sunday	11.30	Morning Praise
3rd Sunday	4.30	The Lord's Supper [Informal Communion]
4th Sunday	11.30	Holy Communion
5th Sunday	10.00	Combined Informal Communion Service for both Churches, usually to be held in Kemsing

Children are warmly welcomed at all of our services. Coffee is served from 11 a.m. before morning services. Evening services are followed by a light meal

Lester Electrical Services

Your Local Electricians

Tel: 01959 52 4032 Mob: 07952 631 708

www.lesterelectricalservices.co.uk

- ✓ Lighting, Sockets & Power
- ✓ Fault Finding & Repairs
- ✓ Consumer Units, Periodic Inspections & Testing
- ✓ Garden Lighting & Power
- ✓ PAT Testing & Safety Testing
- ✓ Associated trades available for complete projects and much more ...
- ✓ Helpful & friendly advice, ideas & suggestions
 - ✓ Free no obligation estimates
 - ✓ Free appraisal of your electrical system

Just give us a call

Ray Lester 01959 52 4032



A J DOE TREE SURGERY

The complete tree care service
For all tree work including stump grinding.

Fully qualified and insured.

01622 728 574

01732 761 726

COPLESTONS

Chartered Accountants
& Registered Auditors

9, West End, Kemsing, TN15 6PX

Local firm serving local businesses & people.
Accounts, audits, corporate & financial advisory
services, commercial & personal taxation.
Contact Alan Copleston or any of our team on :

Tel : 01732 762 886

Fax : 01732 763 924

The Aerial Man

Family Run Business

Welcome to the Digital Age

H.D. REALITY DIGITAL

AERIAL INSTALLATION

NO CALL OUT CHARGE



KEMSING

01732 883542

gardenscape

Home deliveries of
Garden and
Landscaping products

Topsoil • Compost • Manure
Bark • Mulches • Membranes
Turf • Lawn Dressings • Grass Seed
Play Area Surfaces • Raised Beds
Railway Sleepers • Pathway Materials
Decorative Stone • Aggregate

Order Online at
www.gardenscapedirect.co.uk
OR FREEPHONE 0800 854663

KEMSING COMMUNITY CHOIR

The Choir continues to enjoy performing in Kemsing on an occasional basis. Our next event will be a special concert in St. Mary's on **Saturday June 22nd**. With an even more spectacular performance planned, **the Choir will start rehearsals on Tuesday May 7th at 8pm in St. Mary's Church Hall** and will then meet weekly until the performance. (NB Please note new dates of rehearsals).

As always, the Kemsing Community Choir is a true Community event – no auditions, no previous experience, no pressure and no cost to anyone who comes to sing. We would warmly welcome you all to come and join us whether you have sung with us before or not or live in Kemsing or not. Be assured that a good singing voice is not an essential! Just turn up on **Tuesday 7th May** in St. Mary's Church Hall at 8pm. If you would like any further information please email: kemsingcommunitychoir@talktalk.net

We look forward to seeing you all.

Janet Eaton



Need help with your computer?

PC Support



Web Design

Viruses Removed
Systems Overhaul
Internet Services
Network Support

Software & Hardware
Installation / Upgrades
Troubleshooting
Repairs

Friendly Professional Advice & Support for Business & Home Use
Call Andrew Craner

01732 742 454 or 07 957 648 461

Email: enquires@prosphero.co.uk : www.prosphero.co.uk

R. & I. Autos Ltd
Vestry Trading Estate
Otford Road, Sevenoaks



M.O.T. Testing
Repairs & Servicing



M.O.T.s at our
Special Discount Price

01732 450 610

THE SEVENOAKS ARCHERY CLUB

Invite applications from experienced Archers and beginners. Coaching arranged.

Enquiries to: Mike Davies
(Membership Secretary)

48 Childsbridge Lane, Kemsing
Sevenoaks, Kent TN15 6QR
01732 762266

email: membership@sevenoaks-archery.co.uk
www.sevenoaks-archery.co.uk

KEMSING VILLAGE FETE

SAT. 29TH JUNE
In the grounds of
Kemsing School

Details from:

www.kemsing.kent.sch.uk

CHAPMANS CHIMNEY SWEEP

SEVENOAKS
VACUUM AND BRUSH
PROMPT CLEAN SERVICE
ALL AREAS

07 786 325 370

Please support our advertisers and mention this publication



Now in Kemsing....

Local care for your pets

<http://www.elandsvet.co.uk>
vets@elandsvet.co.uk

Main Surgery: 01732 452333
Kemsing Branch: 01732 761650

Our Kemsing branch combines high quality care with genuine compassion – your pets are treated as if they were part of our own family - all with the backup of world leading minimally invasive surgery at our main clinic in Dunton Green

Open: 08.30 – 18.30 Mon-Fri
Except Thursday 08.30 – 11.00

1 High Street, Kemsing, Sevenoaks, Kent. TN15 6NB
01732 761650

Mr P. J. Lhermette B.Sc.(Hons), C.Biol., MSB., B.Vet.Med., M.R.C.V.S.
St John's Church, London Road, Dunton Green, Sevenoaks, KENT. TN13 2TE



01959 525558

OPENING HOURS

★ MONDAY – FRIDAY ★
10.00 - TILL LATE
★ SATURDAY ★
9.00 - 4.00

HOT TOWEL SHAVE BY APPOINTMENT

★ STATION HOUSE ★ STATION APPROACH ★
★ OTFORD ★ TN14 5GQ ★

OPENING TIMES WILL CHANGE IN THE NEW YEAR

DRAINAGE PROBLEMS?
CALL FOR HUNTS
COMMERCIAL AND DOMESTIC DRAIN CARE AND REPAIR

CCTV SURVEYS - PRE-PURCHASE SURVEYS
DRAIN REPAIRS AND INSTALLATIONS
HIGH PRESSURE WATER JETTING
INSURANCE CLAIM CONSULTANCY
PIPE LINING

01732 763994
www.call4hunts.co.uk

KEMSING PARISH COUNCIL REPORT

NOTICE

You are invited as an ELECTOR of KEMSING Parish to attend the Annual Parish Meeting on

Wednesday, 27 March 2013, commencing at 8 p.m. Main Hall, St. Edith Hall.

It would be helpful if you could let the Parish Clerk know if you have any specific questions or proposals. Please submit these in writing by **18 March 2013**.

The business to be transacted at the meeting will be as follows:-

AGENDA:

1. Chairman's Welcome and introduction
2. Approval of previous minutes (available to view at Kemsing Library, notice board at St. Edith Hall or on the Parish Council's website)
3. Matters arising from the minutes
4. Reports from: Kemsing Primary School, Play Place (Youth Club), West Kent Police, Sevenoaks District Councillors, Kent County Councillor, St. Edith Hall Management Committee
5. Questions to Parish Councillors
6. Consideration of any new matters raised by Electors
7. Closure

Parish Council information

Dates of Parish Council meetings: 20 March 2013, 17 April 2013, 15 May 2013

Commencing at 7.30 p.m. usually in the Small Hall, St. Edith Hall, Kemsing

(Please see website and notice boards for further information)

Contact Details

Mrs. Yolanda Tredoux (Parish Clerk)

The Clerk's Office, St. Edith Hall, High Street, Kemsing, Sevenoaks, Kent, TN15 6NA

The office is usually open Monday to Friday mornings from 9.00 a.m. to 1.00 p.m.

There is a 24 hour answer phone (telephone number 01732 762 841) if it is more convenient to leave a message. You can also email to : kemsingpc@tiscali.co.uk or visit website: www.kemsingpc.kentparishes.gov.uk

Parish Councillors

Douglas Bennett, Brian Buttifant, Marie Cole (Chairman), Godfrey Croughton (Vice-Chairman), Bob Dawes, Sally Dickinson, Paul Eaton, Richard Lang, Margaret Robarts, Wanda Ross, Philip Walker, Rosemary Wedderburn

District Councillors

Lorraine Stack & Mark Butler

County Councillor

Nick Chard

Parish Councillor Casual Vacancy

It was with regret that the Council received Mr. John Jermain's resignation. We would like to wish him well for the future and thank him for his contribution over the past few years. As a result of Mr. Jermain's resignation there is now a vacancy for a Parish Councillor. If you are interested in becoming a Parish Councillor, please apply in writing to the Parish Clerk by no later than **1st May 2013**.



IGHTHAM MOTE SPRING OPENING

Ightham Mote is fully open for visitors from **Friday March 1st** – earlier than ever before and for longer. The new extended opening means this beautiful 14th century moated, manor house is available to the public every day of the week until October 31st. Please note pre-booked groups only on Tuesdays.

With a packed programme of events for 2013 there is something for everyone from Attic Tours to Folded Patchwork to the Mikado and a whole host in between!

With Easter early this year enjoy the Easter Trail on Saturday March 30, surrounded by beautiful spring flowers in the stunning grounds.

Other Spring events include Den Building, Past time Historical Dance and Painting restoration - offering a chance to see a conservator in action.

If you have a little spare time and would like to join the team who help to make it all happen, why not come along to one of our Volunteer Open Days and discover how you can make a difference.

Our volunteers are just like you, so come and join us on March 12th 6.30 to 8.30 or April 13th 10.30 to 12.30 – no special skills required just lots of enthusiasm and a friendly personality. For more details call or email Jill Nash 01732-810378 ext.130, jill.nash@nationaltrust.org.uk

Dates for Your Diary:

Thurs March 14 and 21, 10am-3.30pm Folded Patchwork – 2 day course offering an introduction to fabric manipulation. £60

Sat March 30, 11am-3.30pm Easter Trail – follow a trail around the garden to claim your Easter prize. £2.50 after normal admission charge.

Thurs April 18, Attic Tours (places limited, no under 12s)

Sun May 19, Grove singers 2pm and 3pm. Madrigals and sacred pieces performed in the courtyard.

Fri June 7, Embellished Book Covers. £35

Sat 8 and Sat 15 June, Murder at the Mote. Solve the theatrical crime over a 2 course dinner in the Mote Restaurant £35.

For full event listings and further information visit

www.nationaltrust.org.uk/ighthammote or call 01732-810378 ext100 to book an event.

NEWS and NOTES

Kemsing Singers are very much enjoying working with their new Musical Director, Sara Kemsley, but are slowly shrinking in numbers and are especially in need of Tenors. The Singers are a friendly sociable group who meet for rehearsals on a Monday evening in St. Edith Hall and have a wide repertoire of light and more serious music, which they perform for public and charitable occasions. If you are interested in joining email/phone the Secretary, Margaret Holgate, secretary@kemsingsingers.com or 01732 454448

Kemsing Library. We are reminding villagers of the free delivery service of Library books for the housebound. In order to take advantage of this, or if you know of anyone for whom this would be helpful, contact Sevenoaks Library on 0845 8247200, or Kemsing Library on 01732 762199.

St. Mary's North Downs Challenge Walks are on Saturday May 11th, application leaflets are at the back of St. Mary's Church. They should be returned by 20th April 2013.

St. Michaels' School, Otford, would like to gently remind residents that there are no rights of way or public footpaths across the land belonging to the school. This includes the area known as 'The Warren'. The school grounds are bounded to the north by the North Downs Way and to the south by Pilgrims Way.

Kemsing Players April production will be a traditional farce called 'Funny Money' by Ray Cooney, which tells of Henry Perkins' discovery that his briefcase contains £750,000 in used notes. Somewhere nearby a master criminal will find that his briefcase contains Henry's cheese and chutney sandwich rather than the money he was expecting. Performances take place in St. Edith Hall from 25- 27th April inc. See page 31 for details.

Mothers & others extra, in addition to the every Tuesday morning sessions, there will be an extra session on the 1st Thursday in the month, first session on 7th March. A new venture especially for Dads is **Dads & bacon Tots & toys** on the 2nd Saturday of the month. First session on 9th March from 9.0-11.0 bacon for the Dads, toys for the tots. Details from Ruth Mason rmason@argonet.co.uk 01959 524486

Tea and Coffee shop. Val and John at Kemsing Post Office are delighted to announce the opening of their traditional tea and coffee shop in the premises next door (formerly the hairdressers). The intention is to offer an excellent traditional tea room menu with a selection of fine teas and coffee. A takeaway service will also be available.



Central Heating & Gas Engineers

SERVICE	INSTALLATION	REPAIR
----------------	---------------------	---------------

01732 885882**www.samsian.co.uk**



**EKW LEGACY PLANNING
LOCAL WILL WRITING SERVICE
IS YOUR WILL UP TO DATE?**



**A NEW WILL CAN SAVE INHERITANCE TAX AND PROTECT YOUR HOME
AND SAVINGS IF YOU GO INTO LONG TERM CARE**

For a free professional Will review and help with all types of Wills, Trusts, Probate and
Lasting Powers of Attorney

Call our local specialist Tony Nunn on 01732 369294

willplanning@gmail.com www.ekwlegacyplanning.co.uk

KEMSING WATER SOFTENERS Consider the benefits

Softer feeling clothes - No lime scale on taps & showerheads
Lower heating bills - Soaps & detergent usage reduced by 50%
Natural conditioner for fabrics, hair & skin - Bathrooms easier to clean
No installation fee for exchange softener - Non electric softener



'Harveys' block salt, tablets or granules delivered or collected

For more information telephone

01732 760 471

www.kemsingsofteners.co.uk



Kemsing Sports Pavilion

Charity No. 294120

www.kemsingpavilion.org.uk

***Planning a children's
party?***

Well - we can help!
We have a lovely, large room
With self-contained kitchen
and toilets.

Suitable for children's parties
up to age nine.

Want to keep fit?

Have you tried playing squash?

We have a squash court availa-
ble for hire at £6.00

For a 45 minute session.

Showers & changing rooms
available. To find out more & to
book a court, ring us.

**So call us now on : 01732 762 865
Sir Mark Collet Pavilion, Heaverham Road, Kemsing**

What buildings are in the planning application? The application is to demolish the existing Church hall, to build a new Church hall, and to build a new Vicarage at the opposite end of the field in which the hall is situated. The application also includes plans for West Kent Housing Association to build four new homes in Mary Burrows Gardens, and to reconfigure the parking spaces there.

What's wrong with the existing Vicarage? The existing building is overly large and expensive to heat and maintain. Its age means that it needs significant investment, which neither the Diocese nor the PCC can afford.

What's wrong with the existing Church Hall? The present (wooden-clad prefabricated) hall was never designed to stand as long as it has. Showing its age, it needs major repairs to the flooring and the electrics. The Church's needs have grown; the toilet and kitchen facilities are below standard, the Hall is too hot in summer and too cold in winter, and the office-space is too small for our Parish Administrator.

Why does the driveway cross the Churchyard? All the land-owners involved in the planned access route have given their consent, which was not the case with the alternatives. Very careful research has shown that there are no burials in the part of the Churchyard where the driveway will go.

How is all this to be funded? The Diocese will pay for the new Vicarage by selling the current vicarage once everything is completed. The PCC already has 3 sources of funding for the Church Hall: (i) We have been given significant legacies and other donations. (ii) The PCC owns the field in which the Hall is sited; the Diocese will buy part of it to build the new Vicarage. (iii) 50% of any profits made, if the proceeds from selling the Vicarage exceed the building costs of the new one, would go to the PCC.

The remaining costs for the Church Hall would be met by applying to grant-making bodies, inviting local residents to contribute, and other fund-raising activities.

Plans The plans detailed overleaf show the Church Hall Field with the proposed new Vicarage in the north-west corner and the new Church Hall in the south-east corner. A direct path would be introduced from the west door of the Church to give a level path for easy disabled access. The planning application was submitted jointly by the Rochester Diocesan Board of Finance, the Parochial Church Councils of St Mary's Kemsing & Woodlands, and the West Kent Housing Association. Details can be viewed on the Sevenoaks District Council website, application nos: SE/13/00232/FUL & SE/13/00233/CAC.

CHURCH HALL AND VICARAGE

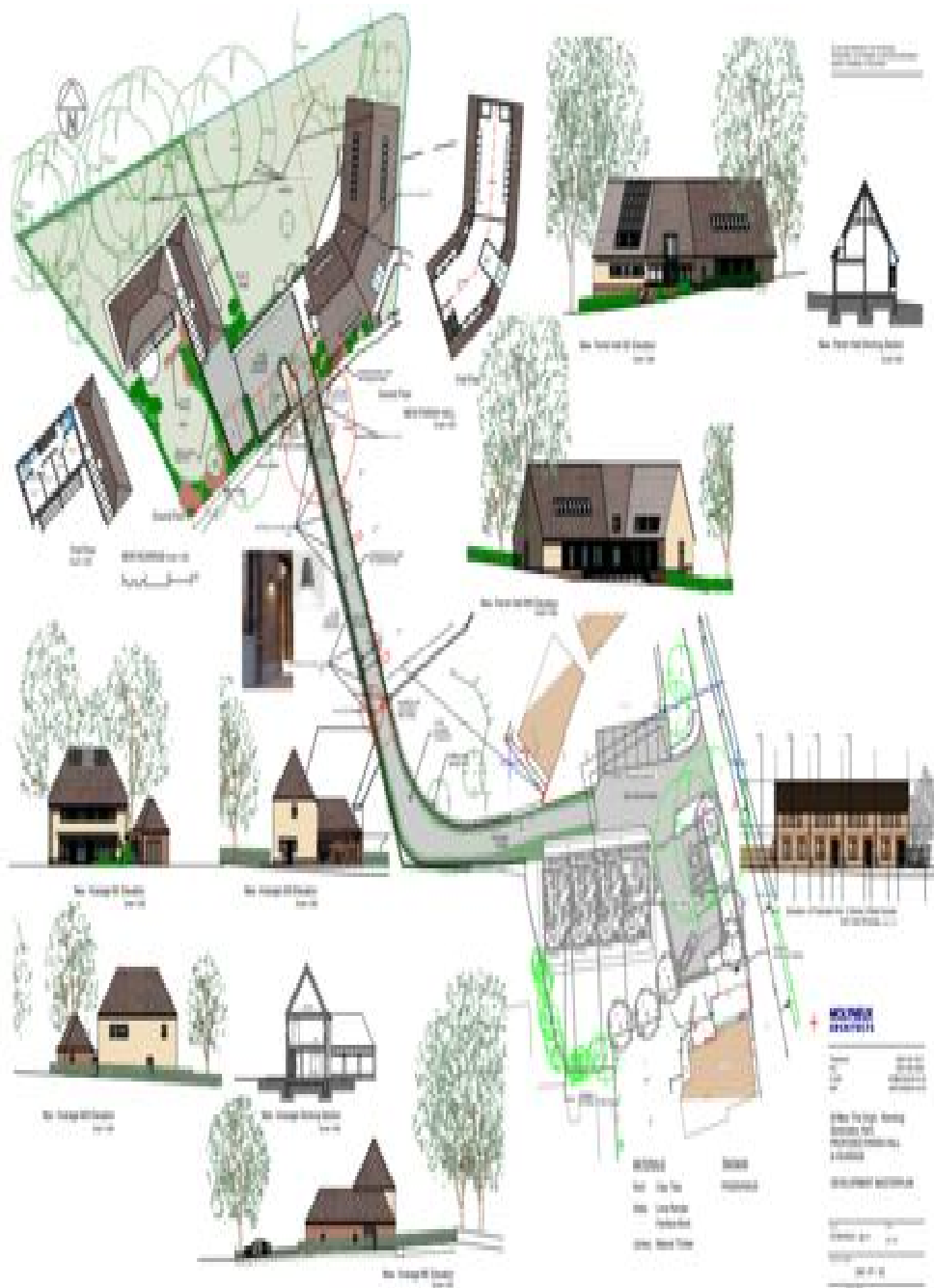



Oldbury Motors

Specialising in



SERVICE & REPAIRS TO ALL MAKES

Latest Diagnostic equipment used. Air Conditioning

Budget to performance tyres at discount prices

Over 30 years experience

We offer super customer care. Our reputation depends on it.

Quality servicing at competitive prices. All credit cards accepted.

www.oldburymotors.co.uk



Retail Motor Industry Federation

01732 763 720

Unit 7, Chaucer Business Park, Watery Lane, Kemsing, Sevenoaks TN15 6PL

Your Local Roofer



Specialists in flat roofing works, Upvc Fascias, Gutters, Tiling / Slate works, Chimney Flashings / Repointing. High Performance Elastomeric Felt & DRYSEAL Fibreglass System up to 25 years Guarantee



(01732) 370426

aquaguard

Email: clive@aquaguard.co.uk

We accept



www.aquaguard.co.uk



FALVEY BROTHERS LTD.

BUILDING CONTRACTORS

LEWIS ROAD, ORFINGTON, KENT, BR1 4AL

Tel: 01689 821550



Specialising in

- EXTENSIONS
- RENOVATIONS
- ALTERATIONS
- MAINTENANCE & REPAIR
- DECORATING

www.falveybrothers.co.uk

LIFE ON THE HILL

East Hill - Knatts Valley - Tinkerpot Lane - Romney Street



I realised that I am becoming a grumpy old woman when my reaction to the sight of a beautiful carpet of snow was one of dismay rather than excitement. Gone are my sledging days – I am now preoccupied with falling over, or skidding on ice. Still, one of the best things about bad weather on the hill is the kindness of neighbours; I am very grateful to ours for their concern.

At St Mary's Woodlands we try to foster this community spirit by running a Lunch Club, Woodlands Tots group and Saturday Café, giving local people a chance to meet in a relaxed informal setting. We are hoping to upgrade the Church Hall, improving the kitchen and providing facilities for the disabled so that it will become a real asset to the community. To help raise money for this, David and Sally Hodges have kindly offered to have a **Summer Fete** in one of their fields.

So mark **Saturday July 6th** in your diary and come along **between 12noon and 5pm** for a great family day out. We already have the promise of a dog show, pony rides, plant stall and cream teas, to mention a few. So when you turn out your cupboards this spring, maybe you'll find something that you could contribute to a stall in the Fete? Sally is able to store things ahead of time if you need. Call Anne (01959 522986) or Sally (01959 523674) for further details.

Don't miss the **"Primrose Walk"**, **Saturday 13th April, 3.00pm at Cotmans Ash**. Brian Doe, will be leading, always an interesting and entertaining guide. For something completely different, we are holding a **"Speakers' Corner"** at **The Rising Sun on Friday April 26th at 7.30pm**. The speaker will be Mark Oden, currently a curate at St Nicholas church, Sevenoaks, who will speak on **"Life in the Marines"**, an intriguing title for a man of the cloth. Includes a light buffet.

Easter celebrations at St Mary's Woodlands – all are welcome! Anne Shelley

MARCH 29th GOOD FRIDAY

9.30 – 10.00 The Way of the Cross – a quiet reflective service *in Church followed by* **10.00 - A United Open-Air service with Kemsing Church** *at the cross on Green Hill, with hot cross buns afterwards in Kemsing Church Hall*

MARCH 31st EASTER DAY

6.30am Sunrise Celebration – *at the cross, Green Hill, followed by breakfast at Garden Cottage, Highfield*

11.30am Easter Family Communion *with a special surprise for the children.*

**DO YOU OWN A
RENAULT?**

Ren7oaks

***Service, Repairs
& MOT's***

*Unit G2, Chaucer Business
Park, Kemsing, TN15 6HU*

www.ren7oaks.co.uk

01732 761200

The Good Garage Scheme Member

EMMA PEACOCK BSc MChs SRCh
STATE REGISTERED CHIROPODIST / PODIATRIST
at South Park Medical Services, South Park, Sevenoaks,
TN13 1ED

A State registered Chiropodist specialising in
providing a comprehensive foot health care service,
including the treatment of corns, calluses, verrucae,
ingrown toe nails & nail surgery.

Morning & afternoon appointments - Home visits

For an appointment ring **Sevenoaks 01732 742529**

(Parking facilities)

Acorn Osteopaths

Seal and Sevenoaks

General Osteopathic Council Registered
Louise Evans B.Ost; Patrick Norman B.Ost
Morn. & Evening Appts + Home Visits
For advice & appointments in Seal

Louise **07780 548143**

Patrick **07786 400260**

For appointments in Sevenoaks

Telephone **01732 760720**

THE BELL



Enquiries: John O'Sullivan

High Street, Kemsing

Tel: 01732 761 550

Good home cooked food
from 12 noon all day

Private Room available for Functions/Parties

Euromotors Est 1908

FULL CAR SERVICING & REPAIRS



**Diagnostic fault finding - Air conditioning service and repairs
Bodywork - MOTs - Collection & delivery available
& Courtesy car by arrangement.**

The Good Garage Scheme

Telephone: 01732 763644 **www.euromotors.org.uk**

A1 Chaucer Business Park, Watery Lane, Kemsing, Sevenoaks, TN15 6PW

Please support our advertisers and mention this publication

Kemsing School Report

A belated Happy New Year to everyone! After a fun and refreshing Christmas break, school is back in full swing and all children are ready for the new term.

The Autumn term proved very busy for the children. The Choir sang at a special event at Ightham Mote and did a fantastic job. They were required to sing outside in nippy weather—no easy feat—and tackled a very difficult song from the hit West End show Matilda. The Choir’s version of ‘When I Grow Up’ was a real hit and proved a show-stopper during the KS2 Christmas Celebration.

The Christmas season got a lovely start with the PTA’s Christmas Fayre on 1 December. The school was transformed into a bazaar, full of tasty food, fun activities and lovely Christmas gifts. The Kemsing Community Choir serenaded the crowds with Christmas carols, and Santa entertained the children in a special grotto.

A highlight of the autumn term for KS2 had to be the trip to the Polka Theatre in Wimbledon to see ‘The Wind in the Willows.’ The children piled onto a coach and double decker bus—an adventure in itself—and enjoyed a lovely afternoon in the company of Mole, Ratty, Badger and the gloriously outrageous Mr Toad. The play took place in a bespoke children’s theatre and proved a hit with the children and staff alike.

Of course, the last weeks of the autumn term are dominated by theatre, as the KS1 children rehearsed their nativity play, ‘Christmas with the Aliens’. It was a genuine success, with aliens learning the meaning of Christmas. The children mastered an impressive number of songs—as well as their lines—and performed beautifully. They set a high standard for KS2!

The KS2 Christmas celebration focused on Christmas and festive songs chosen by the classes and their teachers. The show launched with the perennial favourite, The Twelve Days of Christmas, and concluded with a rousing performance by the Choir. Each class performed a song, and Class 6 sang and ‘signed’ their contribution, ‘Wonderful World’.

Alongside the creative arts, Kemsing Primary School made an outstanding showing at the Lego science competition, taking home the trophy for best presentation. Year 6 children designed a personalised robot companion for the elderly, who not only provides good company (answering commands) but also provides good organisational services (managing diaries and medications). The design and configuration of the robot showed not only imagination, but a deep care and concern for the needs of the elderly. Congratulations go to our science team for taking home another trophy for Kemsing.

With Christmas behind us, everyone at KPS is looking toward spring. The PTA have a number of activities planned, and we hope to see you at one of these events in the near future. Thanks to the community for the great support you continue to show the school and its lovely children.

Elaine Bracken
Teacher, Year 3

The Village Framer

Quality at an
affordable price



Artwork
Needlework
Pictures & Posters

www.villageframer.co.uk

graham@villageframer.co.uk
07858 126427

1 Chart View, Kemsing, TN15 6PP
Please call for appointment

SHEFFORDS
CHARTERED SURVEYORS
EST. 1887

- Building Surveys
- RICS Home Buyers Reports
- Valuations
- Development Consultancy
- Property Refurbishment Consultants
- Rent Review Advice
- Party Wall Matters

13, London Rd, Sevenoaks, TN13 1AH

Email : 7oaks@sheffords.co.uk

www.sheffords.co.uk

01732 450860



**Kemsing Motor
COMPANY**

- * MOT Tests (Cars & Diesels)
- * Servicing & Repairs to all makes of car
- * Full Diagnostics
- * Air Conditioning Servicing
- * Servicing & Repairs to motor cycles
- * Parts & Labour Guarantee
- * Free Collection & Delivery within 10 mile radius
- * Courtesy Car available by arrangement
- * Friendly & Helpful Staff
- * Member of RMIF Quality Control Programme

9, West End, Kemsing, Sevenoaks, Kent.

Tel: 01732 761 372

Fax: 01732 761 336

www.kemsingmotorco.co.uk



Service Partner



HELPING HAND DRIVING SCHEME

It's probably time again to talk about this Scheme. We are there to help elderly, disabled and other disadvantaged people to get to medical appointments, to visit relations in hospital and occasionally to social events. Obviously friends, relations and neighbours may be able to help but if not, give us a call.

But we need help! Firstly to widen the number of people we assist. We have a reasonable list of "regulars" but it is probably a only small percentage of the possible needs. If you think we could help you or if you know someone nearby who could benefit please give me a call.

We also need more drivers. The commitment is not great - it averages at about 2 drives per month and no-one has to do a particular run if it is not convenient on that day - I just move on to the next driver on the list. Destinations are 50% local and 50% Maidstone, Pembury and other hospitals - some petrol money is paid for the longer journeys.

So please phone me on 01959 522490 to discuss what you need or what you can offer. Thank you.

Alastair Boobyer

ST. MARY'S FUND RAISING TEAM

The team are as busy as ever undertaking fund raising for the benefit of the Church.

The next item is a *Quiz* on **Saturday 16th March** in the Church Hall with Bob Dawes. Starting at 7.30pm, the tickets are priced at a very reasonable £5 each, bring your own drink, glasses and nibbles. Teams can be up to eight people, but can be made up on the night. Please contact Margaret Robarts in the Parish Office on 01732 761351, leaving a message if she is not there!

On **Saturday 20th April**, Joyce Course is arranging a *Moroccan lunch*. Fantastic value at £15 per ticket for a 3 course Moroccan inspired meal, what a bargain! Again, contact Margaret Robarts at the Parish Office to put your name down for a ticket.

There will be a *cake and plant sale* on **Saturday May 4th** in the Church Hall starting at 10am. An ideal opportunity to come and stock up with summer bedding and buy a cake at the same time. Refreshments will be available.

And last, but not least, the *Community Choir* will be singing in the Church on **Saturday June 22nd**. Interval refreshments will be provided by the fund raising team, so come along and join them all. There is bound to be a chance for a bit of a sing-along! Entrance will, as usual be free, with a small charge for the refreshments and a retiring collection.

There is also an opportunity for assisting Church funds, by taking part in recycling. There is a large box in the entrance to the Church Hall in which you can place ink-jet printer cartridges, laser cartridges and unwanted mobile phones which can all be recycled and earn money for the Church.

DOWN TO EARTH



Professional Tree Management

All aspects of tree care [planting to felling]

Hedge Cutting

Stump Removal

Over 30 years experience

Logs

For help & friendly advice call our office

01959 524 623

The Oast, Preston Farm, Shoreham,
Kent TN14 7UD Tel.

Email : enquiries@downtoearthtrees.co.uk

Website : www.downtoearthtrees.co.uk

SGE (SEAL) LTD

(Seal Engineering)

Church Farm, Church Street, Seal, Sevenoaks TN15 0AT



We offer:

- ✦ CAD facilities & Design service
- ✦ Manufacture bespoke products
- ✦ Fabrication & Machining work
- ✦ Steel beams, weld mesh, etc.
- ✦ Delivery & installation service

We also provide:

- Plumbing & pipe fittings
- Swimming pool hypochlorite
- Ironmongery & hardware goods, including nuts & bolts
- Field gates, stock fencing & water troughs
- Horse matting & animal bedding solutions
- Electric fencing products & servicing facilities
- Electrical installation & flood lighting
- Sundry items including overalls, gloves & footwear

Tel: 01732 761724

Fax: 01732 761422

email: sales@sgeseal.com

OPENING HOURS

Monday - Friday: 08:00 - 17:00 Saturday: 08:00 - 12:00

THE ST EDITH CLUB

Affiliated to the CIU

Evenings 7 -11 p.m. & Sunday Lunchtime 12 -3.00 p.m.

Fridays evenings open at 5pm. Sunday Evening 7 -10.30 p.m.

Why not come along and join us.

Membership open to anyone

Over the age of 18.

Full membership £10.

DARTS

QUIZ NIGHTS / LIVE ENTERTAINMENT

Please Phone 01732 762 755 for details or call at the door

CIU Associate card £3.00

There is a £6.00 refundable door fob deposit.

Raffles every Friday night & Sunday Lunchtime.

Next to the Village Hall, High Street, Kemsing TN15 6NA.

No joining fee

Over 60 £5.00

BINGO
POOL

CRIB
SOLO

News from Cotmans Ashand home to Kemsing

Ask a man or woman of Kemsing “Where do you live Mate?” and he will say to you, “Kemsing – Where else?” That sums up the feeling and love we people have for our village – you can understand that feeling when you first come as a visitor to our village, whatever the direction you travel, westward from Wrotham, eastward from Otford or in from Seal and Sevenoaks to the south, and whether it is Spring, Summer, Autumn or Winter, your first vision, your overriding impression will be hills, trees and open grassland; but it is not an architects mind that planned the landscape that you see or the layout of some master gardener, it is the product of a million years of weather and gradual evolution, the chalk rock, the flint stone, the great gashes and craters in the rugged downs that have been torn out and fashioned by the winds and storms of centuries past. The trees, shrubs, and open Downland you see today have all taken their place in the footsteps of time, and on the same ladder have come birds, mammals, insects, flowers, fungus and even man himself. That is the mainspring of the beauty and fascination you see before you today. Who is there who would separate them out from the web of life? Who would want to? They are the backbone of our village!

The trees, plants, animals and birds you see today will be not unlike any other seen by travellers over the centuries or even Chaucer’s pilgrims journeying anywhere on the chalk route between Winchester and Canterbury – only the sombre green yews, gaunt and disfigured by the storms of centuries past bear witness to this ancient place – they also provide food and shelter for numerous birds, flocks of finches, thrushes and warblers, even the tiny goldcrest who slings her little hammock of mosses and lichen under the branches. Because of their great age and ability to survive in deprived conditions of pure chalk rock, great caverns form in their roots creating homes for badgers, foxes and rabbits in the warm dry chalk shelves – woodpeckers hammer into the bark for insects and tree creepers tuck their nests into the old shattered limbs.

A familiar sight from my high point on the Down at dawn or dusk is the large flights of black headed gulls in the southern sky who travel daily from the tip at Sundridge to the Medway estuary. Often in the same sky skeins of greylag geese honk and call to one another on their way home to the Wild Fowl Reserve at Bradbourne. Another early riser and great fisherman is the heron –long before Kemsing folk rise from their beds, he has plundered their fish ponds of goldfish and even frogs.

Now from my high seat rooks and jackdaws cross the evening sky calling and arguing amongst themselves as they journey westwards into the evening sunset – a molten ball, heaving and billowing in the blue margin between earth and sky as all goes quiet, until the creatures of the night take over, when your ears will serve you better than your eyes. A hunting vixen, her wailing scream echoing across the downland – rabbits drumming their warning of some unseen enemy, bats bouncing their almost inaudible signal as they navigate through the trees, and badgers, who have a tremendous range of sounds, from barking like dogs, squealing like piglets, sobbing like a child in distress to a high pitched scream – so much is known of badgers – so little I know of their language.

Tawny owls are night hunters. They too have a wide vocabulary – their familiar ‘to-whit-to-who’ to all sorts of little snores and grumbling. Herons cross the night sky ‘Fraank Fraank’ they call. In winter moonlight, not only will you see the Great Bear, the Milky Way or Orion striding his way westward to Otford, but large formations of ducks and many other wading birds, whose call and shapes I have never been able to identify, as they pass across the face of the winter moon.

“Where else would you live Mate?”

Brian Doe

FAREWELL TOM



Tom went from Orchard Way in December last year to go and live with his daughter in Crowborough. A presentation was made to him at the Church Hall.

Tom was born in 1920 near Harwich in Essex and in 1938 he joined the Home Office and was seconded to the Metropolitan Police. When WWII came he joined the Royal Artillery and was posted initially at home becoming a signals expert. In January 1942 he was commissioned as a 2nd Lieutenant, although he then had to become proficient at gunnery and so was sent for more training. This was fortunate because he married Doris (whom he had met when her parents lived in

Hildenborough) at St Mary's, Riverhead later on in 1942. – their first home was in Wimbledon.

Tom was being trained for the invasion of North Africa but was the victim of an accident that caused an injury to his leg. He thus missed the Allied landings in France but was sent to Germany in 1945 (after an intensive course in German) to help de-commission the German Army. He was finally released from the Army in the Autumn of 1946 with the rank of Captain. He joined London County Council, and worked in a division responsible for housing. After the formation of the GLC in 1974, worked for a further 10 years in Highways Construction before he retired.

In 1945 Tom's parents in law had bought a house in Dynes Road and Tom and Doris set up home there from 1946. The couple had three children: Tony, Barbara and Philip and moved to Orchard Way in February 1956 and Doris (who sadly died in 2006) began a career in local politics being first a member of the Kemsing Parish Council and ultimately the Chairman. She then became a member of the Sevenoaks RDC and was ultimately its Chairman, and then Chairman of the present Sevenoaks District Council. She would not have been able to follow this path without the strong support of her husband.

Doris' career did not leave Tom time to pursue other interests but he was very much involved in Church administration having attended St Mary's since 1946/7. He became the Secretary to the Parochial Church Council and was elected Vicar's Churchwarden, a position he held from 1966 until 1982. He was also a noted thespian and was a founder member of the KADS which became the Kemsing Players and Tom appeared in many plays.

Tom was a true gentleman of Kemsing and our best wishes follow him to his new abode.

Alan Waters

Success at 11 for boys and girls

At Russell House School in Otford, all 18 children who took the 11-plus exam for secondary school entry in September 2012 passed with an average score of 411. Six children gained full marks.

We ensure children are well prepared for all exams at 11, while enjoying a full curriculum where music, sport and drama are also pursued to high levels of achievement.

Children thrive at Russell House within a happy, friendly and welcoming environment where we establish positive attitudes to learning and life which will benefit them long into the future.

We welcome boys and girls from the age of two and children join at other ages where spaces are available. Call to find out more.



Russell House School

Station Road, Otford, Kent TN14 5QU

Tel: 01959 522352 www.russellhouseschool.co.uk



WELHAM JONES

Funeral Directors & Monumental Masons

01732 742400 or 01959 525440 : 01732 780600

156 London Road, Sevenoaks, TN13 1DJ

43 Western Road,
Borough Green, TN15 8AN

www.welhamjones.co.uk

An Independent Family Owned Company

24 hour
service

Pre-paid funeral
plans available



FAMILY MILESTONES

Baptisms

Alessina Astie on 16th December 2012.

Deaths—Rest in Peace

Martin Hobbs (77) on 26th November 2012

John Thwaites (87) on 14th December 2012

Jessica Burgess (101) on 27th December 2012

Ronald Holloway (85) on 27th December 2012

Eric Whitehead (90) on 31st December 2012

Patricia Willmott (82) on 2nd January 2013

David Watson (80) on 13th January 2013

Gladys Whitehead (90) on 16th January 2013

Paul Slate (83) on 10th January 2013

Peggy Lowes (91) on 19th January 2013

Frank Rosier (74) on 28th January 2013

Hilda Reeves (91) on 10th February 2013

From Kemsing Church & Village News

Extract from “Kemsing Church & Village News” 1963

The **St Mary’s Thrift Club** was still in existence and thanks were due to Mrs Marsh who had kept it going and to Mrs Parkin of St Edith Farmhouse who had offered to continue it. The **Parish Council** approved the draft of an agreement with the **Parochial Church Council** for the financial management of the extended Churchyard. Mr **Mark Baldwin** was to give up looking after the St Edith’s Well area which he had done for many years. **George Baldwin** would take his place. The Church **Organ** had expired and the congregation and choir were managing with a piano (and sometimes with a tuning fork!).

Extract from “The Well” Spring 1988

Vic Bowden contributed an article about **St Edith’s Farmhouse** detailing the construction and ownership of the old house, which had a foundation stone dated 1656 and the new house, which had been built in 1956. Doug Kitchener wrote of the events of **The Kemsing Gardener’s Society** which maintained a trading hut by the entrance to Kemsing School. Peter Farr wrote about the **Poverty and Hope Appeal** that is well supported each year by the community in Kemsing. Money is sought for development projects for poor communities overseas. This year’s project was about Stone Crushers in India.

The **Frank Johnson Memorial Fund** had been set up and was set to benefit from an organ recital in the Church by Bruce Burbridge (an organ scholar at Westminster Cathedral) and Christopher Angel (Assistant Organist at Coventry Cathedral).

DMB LAW

Solicitors

Helping you move forward



Property & Conveyancing
Company & Commercial
Wills, Trusts & Probate
Family & Matrimonial
Dispute Resolution
Employment

For enquiries please contact

01732 228800 E-mail: legal@dmblaw.co.uk

**The Old Bat & Ball, St. John's Hill, Sevenoaks Kent
TN13 3PF**

Visit our website: www.dmblaw.co.uk

THE NORTH DOWNS SCOUT CENTRE

Coming soon to Kemsing!

Kemsing Scouts are engaged in a challenge to build the finest Scout Centre in the Country, here on the North Downs on the Common Field Recreation Ground. They need to raise £350,000 and they need your help.



What can you do to support them? Can you get sponsorship at work (£ for £), would you like to sponsor a part of the new building? Are you a local firm and want to be a part of the Community, supporting Kemsing Scouts? Any other ideas?

Please support us now!

6th Sevenoaks (Kemsing) Scout Group. Call Chris Arnold, Group Scout Leader on 01732 762774 or email: info@northdownsscoutcentre.co.uk

Cubs and Scouts from the 6th Sevenoaks



Picture courtesy of the Sevenoaks Chronicle

Village Diary

March

- 1st Kemsing Heritage Centre 7.30 St. Edith hall, talk by Chris. McCooley 'War Time Diaries of a South Coast Woman' Members free, non members £2.50
- 2nd Kemsing Heritage Centre open 1st Saturday in the month 10.00-12.00
- 4th Kemsing Heritage Centre open every Monday 2.00-4.30 except Bank Holidays
- 8th Wildlife Group 8.00 St. Edith small hall, talk by Robert Canis 'Wild Life of the North Downs' £2
- 9th Dads & bacon, tots & toys 9.0-11.0 St. Mary's Church hall details R.Mason 01959 524486
- 12th Kemsing Gardeners AGM an evening with Brian Doe 8.00 St. Edith small hall
- 13th W.I. St. Edith small hall 7.45 talk by Dennis Chambers 'Kent Ghosts'
- 15th Blood donor session Sevenoaks Community Centre phone 0300 1232323 to book an appointment or drop in 1.30-4.15 and 5.30-7.30
- 16th Scout Jumble Sale, donated items to St. Edith hall from 9.30 am. Sale starts 1.30 pm entrance £1.00 per adult children free
- 21st Trefoil Guild meeting 7.45 St. Edith Church Hall
- 23rd Easter Egg Bingo At Kemsing School. For more information contact the school .
- 27th **Parish Council Annual Meeting. St. Edith large hall 8.00 All Kemsing residents welcome.**
- 28th—31st **EASTER SERVICES, see page 3 for details**

April

- 1st Box office opens for Kemsing Players traditional farce 'Funny Money' tickets £8.00 seniors cessions on Thursday 25th only . Phone 0755 476 6335 for all tickets
- 5th Kemsing Heritage Centre talk by Bob Ogley 'Victorian Kent' St. Edith small hall 7.30 members free, visitors £2.50
- 6th Kemsing Heritage Centre open 1st Saturday in the month 10.00-12.00
- 6th Kemsing Gardeners Spring Show, school hall 2.30
- 9th Kemsing Gardeners talk by Graham Usher 'Gardens of Gertrude Jekyll' 8.00 St. Edith small hall
- 10th W.I. 55th Birthday meeting 'Songs from the 20's to Present Day' by V. Mackenzie 7.45 St. Edith small hall
- 12th Kemsing Wildlife Group. 'A Wild Wet Wilderness' by I. Palmer. 8pm. St. Edith small hall. £2.
- 20th Closing date for applications forms for the North Downs Challenge Walk. Application forms from P. Mallinson 01959 524725, cost £12.00 adults, under 18's £5.00. Entries will not be accepted on the day.
- 21st Kemsing Heritage Centre **Churchyard walk** . Starts 2.00pm from village car park, adults £2 children free
- 24th Orford & District Wine Club meeting 8.00 Sparkling Wine Tasting, details Olive Cherry 01732 458240
- 25th **Annual Parochial Church Meeting.7.45pm Church Hall.**
- 25/26 Kemsing Players traditional farce 'Funny Money' by Ray Cooney St. Edith large hall. Ticket sales as above .Details see 1st April.
- 27th

May

- Date to be arranged for a visit to Riverhill Gardens by Kemsing Gardeners Association.
- 3rd Kemsing Heritage Centre talk 'Finding my Place' with book signing by Brian Rance. St. Edith small hall 7.30 Members free, visitors £2.50
- 4th Kemsing Heritage Centre open 1st Saturday in the month 10.00-12.00
- 7th and every Tuesday—Community Choir rehearsals . St. Mary's Church Hall 8pm. All welcome.
- 8th W.I. Annual meeting & Resolutions St. Edith small hall 7.45
- 10th Kemsing Wildlife group. 'Gloworms' by John Tyler. 8pm. St. Edith Small hall. £2.
- 11th North Downs Challenge walk, for details see above 20th April.
- 18th The Kemsing Singers Concert, 'Crossing Continents' 7.30 St. Edith Hall, tickets from R. Edmunds 9 Cleaves Road, Kemsing 01959 523752
- 23rd Kemsing School. Happy's Circus. Tickets from Kemsing School.

June

- 1st Kemsing Heritage Centre open 1st Saturday in the month 10.00-12.00
- 7th Kemsing Heritage Centre talk 'Oldbury Hillfort & its Trackways' by David Williams St. Edith small hall 7.30, members free visitors £2.50
- 11th Kemsing Gardeners 'Down to Earth' talk on soil testing, compost etc. talk by Steve Bradley 8.00 St. Edith Small hall.
- 12th Kemsing Evening W.I. Garden Meeting.
- 23rd Kemsing Heritage Centre **Reptile Walk**. Starts 2.00 from village car park, adults £2. children free.



Able Decorators

Specialists
in interior &
exterior painting
& wallpapering



Call now for a
FREE ESTIMATE

01732 456208

07946 280453

or email abledecs@aol.com



Member of the
Federation of
Master Builders